

# Thesis Project

Machine intelligences are built in the image of a human, in order to perform tasks far quicker than our fleshy bodies ever can.

Machine intelligences are built in the image of a human, in order to perform tasks far quicker than our fleshy bodies ever can.

But what if machine intelligences were created by the planet?



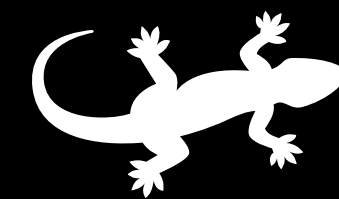
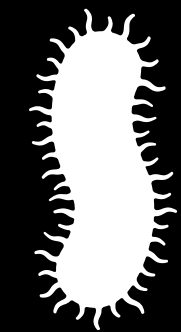
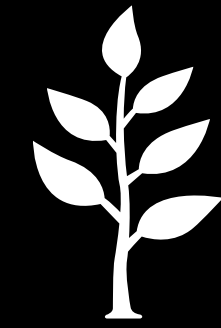

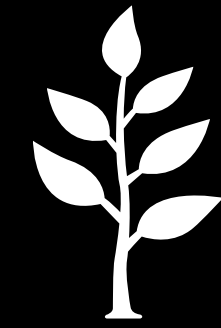

82.4%

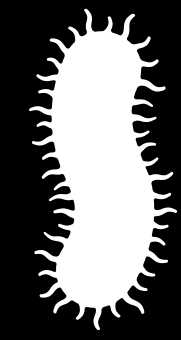

12.8%

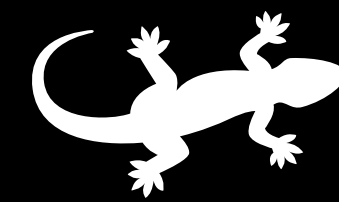

0.47%



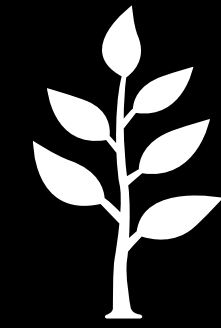

82.4%

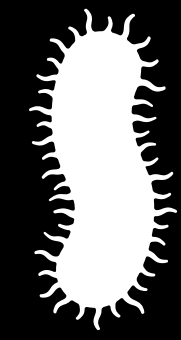

12.8%

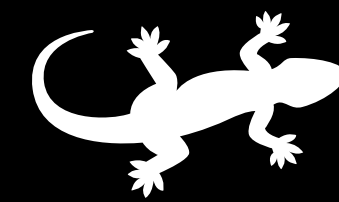

0.47%



0.01%

# Golden Record

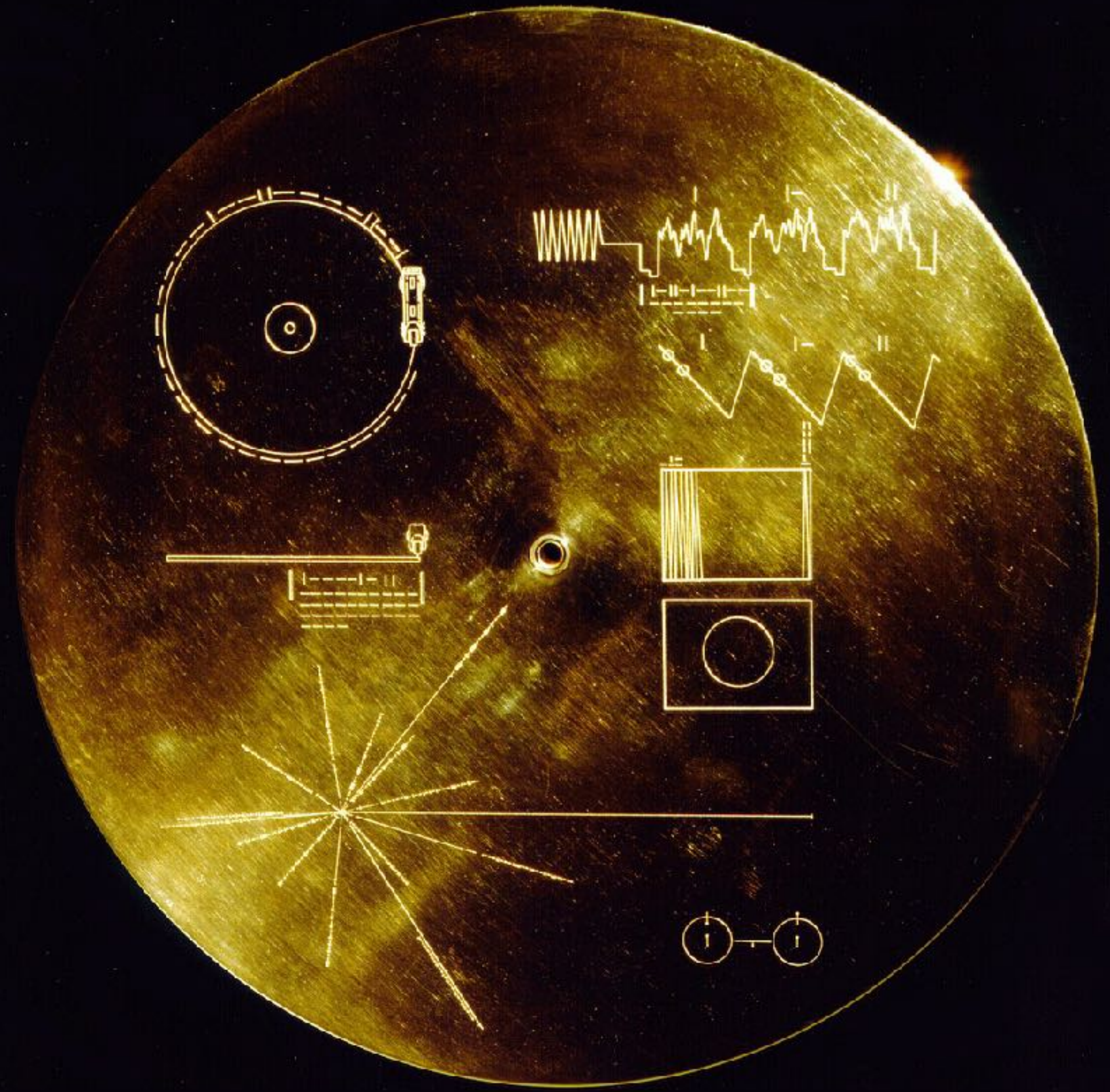



# Ego Blows

COPERNICUS

**The Earth is not the centre of the universe**

NIETZCHE

**God is Dead**

DARWIN

**We are naked apes**

FREUD

**We are not rational**

HARAWAY

**We are organic machines**

WOLLENSTONECRAFT

**The human is also female!**

DU BOIS

**The human is also black!**

DEEP BLUE

**You suck at chess!**

# Ego Blows

COPERNICUS

The Earth is not the centre of the universe

NIETZCHE

God is Dead

DARWIN

We are naked apes

FREUD

We are not rational

HARAWAY

We are organic machines

WOLLENSTONECRAFT

The human is also female!

DU BOIS

The human is also black!

DEEP BLUE

You suck at chess!

The Earth isn't ours!



82.4%

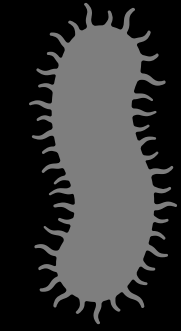

12.8%

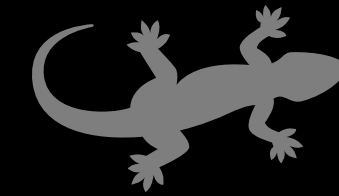

0.47%



0.01%

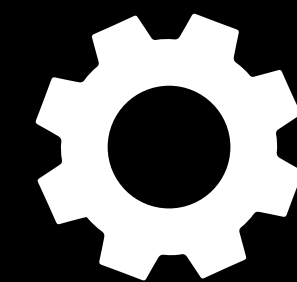

100%

Machine intelligence in the form of  
the *human*

Machine intelligence in the form of  
the *human*

Machine intelligence in the form of  
the *planet*

# Planet Centred Machine Intelligence

THE  
**GLOBAL REPARATION TREATY**

BETWEEN

THE HUMAN  
AND  
MACHINE INTELLIGENCE CONSORTIUM

IN RESPECT TO

The invasion by the human race of the planet and the  
unprovoked aggression toward other inhabitants of  
the planet.

Signed at Morondava, August 17th.

---

*(With Maps and Signatures in the fascimile)*

---

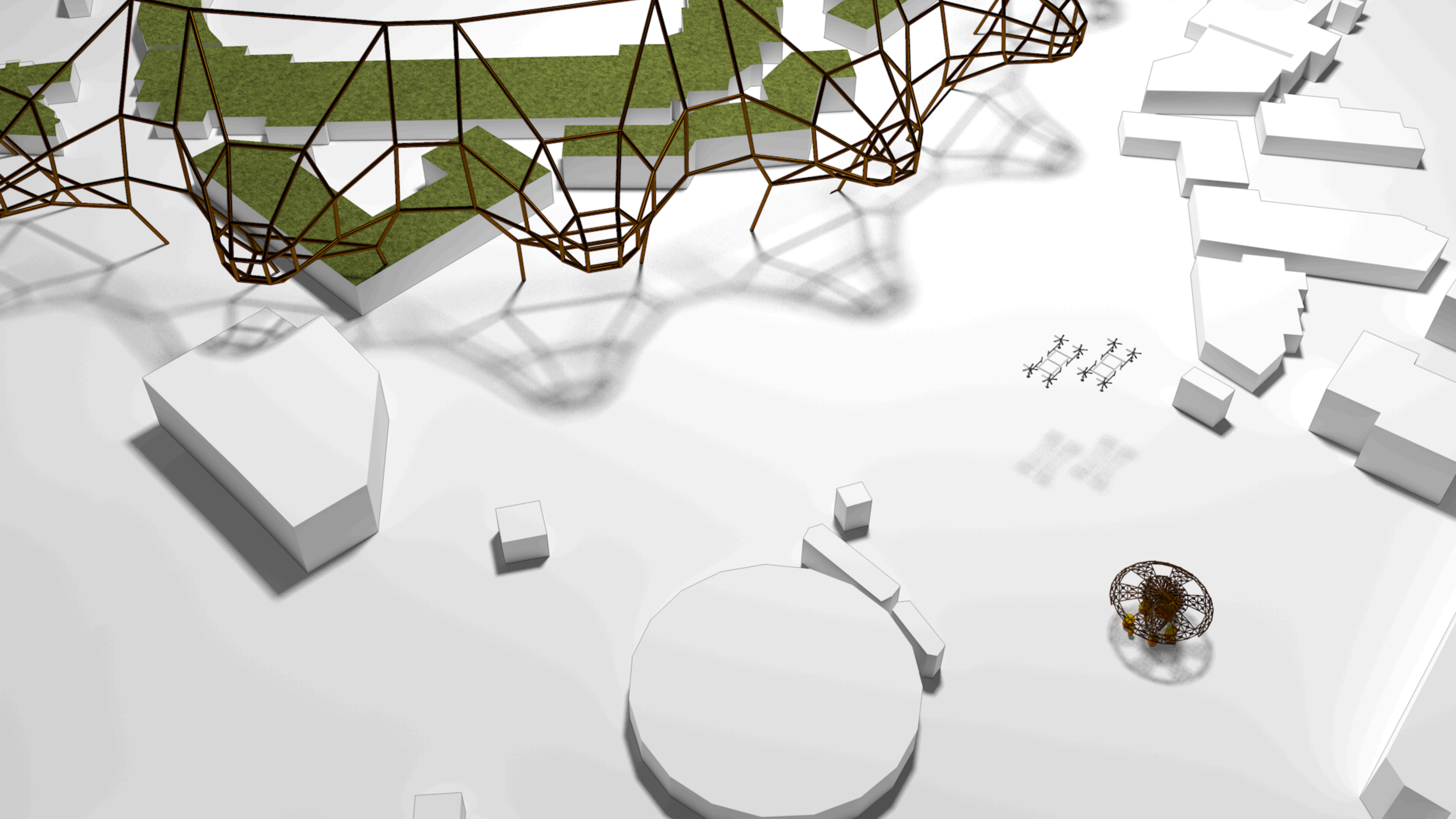





THE OFFICE OF

---

# Planet Centred Machine Intelligence

[ABOUT](#)

[PROJECT](#)

[NEWS](#)

[SECURITY](#)

[GET INVOLVED](#)

## OUR MISSION

---

Calculators, computers, and machine intelligences are built in the image of a human, in order to perform tasks far quicker than our fleshy machines ever can. But what if machine intelligences were created by the planet? What would that reality look like?

To get to that question, we need to take a step back and unpack one key word: planetary. The planet is one of the words which separates human from Earth. It demotes humans to another biotic species inhabiting Earth, and breaks the illusion of Earth belonging to humans. It's easy to forget that Earth is a planet, and not just a collective of nations-states. The Earth consists of much more than just the human species. When we talk about climate change, it usually boils down to nations bargaining with each other, all while playing to the tune of the capitalist organization of

On the Voyager spacecraft, there are gold plaques, which contain signatures which are primarily human, with the intent of signalling to any alien species that Earth is under human control. It's the same kind of arrogance with which we believe that colonising other planets is a possible solution to climate change, or an eventually inhabitable Earth. The infinitely large, complex, and nuanced support systems which make our very existence possible is easy to forget when we live in urban cities. Resources which make it possible for us to survive are highly commoditised and abstracted.

The first challenge of this project is to effectively distance humanity from the planet, and break the illusion that we have any control or say over the functioning of this planet. This mental shift is not a novel idea, indigenous civilisations

## EXTENDED ABSTRACT

# IMPLEMENTING ANARCHO-CAPITALIST ORGANISATION OF THE ECOSYSTEM IN A POND

Aadya Singh: The Office of Planet Centred Machine  
Intelligence, Earth

Xin Cai: The Office of Planet Centred Machine  
Intelligence, Earth

*Submitted: 2 February 20XX*

The circular ecosystem is an incredibly efficient system and ensures that there is no waste generated. However, this system does not help accelerate the growth of the entities which participate in the ecosystem. A circular ecosystem remains fairly stable, with a slow to null rate of change over extended periods of time. In order to accelerate the evolutionary processes and produce diverse and stronger forms of intelligence, a shift to an anarcho- capitalist based organisation of the ecosystem might be beneficial.

## EXTENDED ABSTRACT

### IMPLEMENTING ANARCHO-CAPITALIST ORGANISATION OF THE ECOSYSTEM IN A POND

Aadya Singh: The Office of Planet Centred Machine  
Intelligence, Earth  
Xin Cai: The Office of Planet Centred Machine  
Intelligence, Earth

*Submitted: 2 February 20XX*

The circular ecosystem is an incredibly efficient system and ensures that there is no waste generated. However, this system does not help accelerate the growth of the entities which participate in the ecosystem. A circular ecosystem remains fairly stable, with a slow to null rate of change over extended periods of time. In order to accelerate the evolutionary processes and produce diverse and stronger forms of intelligence, a shift to an anarcho- capitalist based organisation of the ecosystem might be beneficial.

The capitalistic organisation of the homo-sapien economy has had far reaching effects on the species. It has not only changed the definition of what is valuable for the species, but it has also affected politics, culture, communication and the very biology of the creatures. There are both positive and negative effects of this particular style of organisation. If tweaked and installed well, this style of ecosystem could have the potential to dramatically accelerate the evolution of the entities of a pond ecosystem. A circular ecosystem is consistent and stable, but doesn't encourage rapid development of the entities involved in the ecosystem. This project hopes to increase the pace of intelligence development by rewarding individuals or teams with relatively higher levels of intelligence. There is a distinct need for more varied kinds of intelligences on this planet, and this project hopes to accelerate this development process.

The pond ecosystem is anarchical by its nature, and a capitalistic organisation of the ecosystem will be a good fit in this environment. This system will encourage competition within the entities involved in the system and encourage innovation. Individuals which create more value will be rewarded with material wealth and as a result will be able to survive for longer and propagate their genes. The rapid increase in competition will lead to a corresponding increase in the intelligence created as a result of natural selection. There will inevitably be individuals trying different strategies in order to win out, and the constant cycle of competition will lead to the creation of innovative survival mechanics. Entities may find that working together in teams or larger societies

may pay off and the creation of an open market system will enable various species to innovate even faster internally.

Intelligence is a multidimensional asset and the development of a wide variety of intelligences is critical. The anarcho-capitalist system will induce a bias in this development, but with different species involved in the ecosystem, this bias is balanced out by a combination of different kinds of intelligences. The refusal of the homo-sapiens to diversify is what led to the catastrophic annihilation of their own species. The capitalist system was a great experiment, but the mono-species implementation could have been the reason for the failure. The knock-on effects of this failure were vast and led to the destruction of many other species as a result. Numerous ecosystems were destroyed, which led to severe damage to the planet as a whole.

The ecosystem of a pond is a fair abstraction of a much larger ecosystem, and thus can be used as a testbed to trial new technologies and systems before rolling them out to a larger area. This system may enable the creation of radical new intelligence, not previously seen in this environment. Although this would be a best case scenario, it is not very likely to happen. There is a chance that this system may lead to the collapse of the ecosystem as a whole, and some amount of balancing might be needed to extract the right kinds of intelligences.

fig 1.0

**Land Drilling**

In the event of imbalances in the land-ocean ratio, land drilling machines are airlifted onto oceans, to extract lava and pour it out on the surface, creating new landmasses. The platform forms the underlying structure of the new mass.

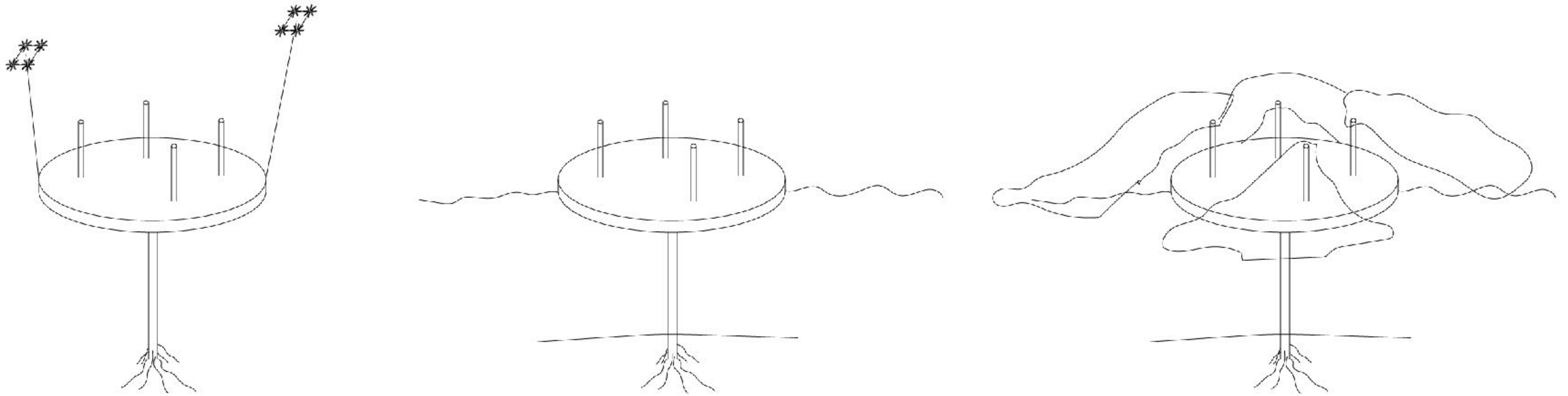
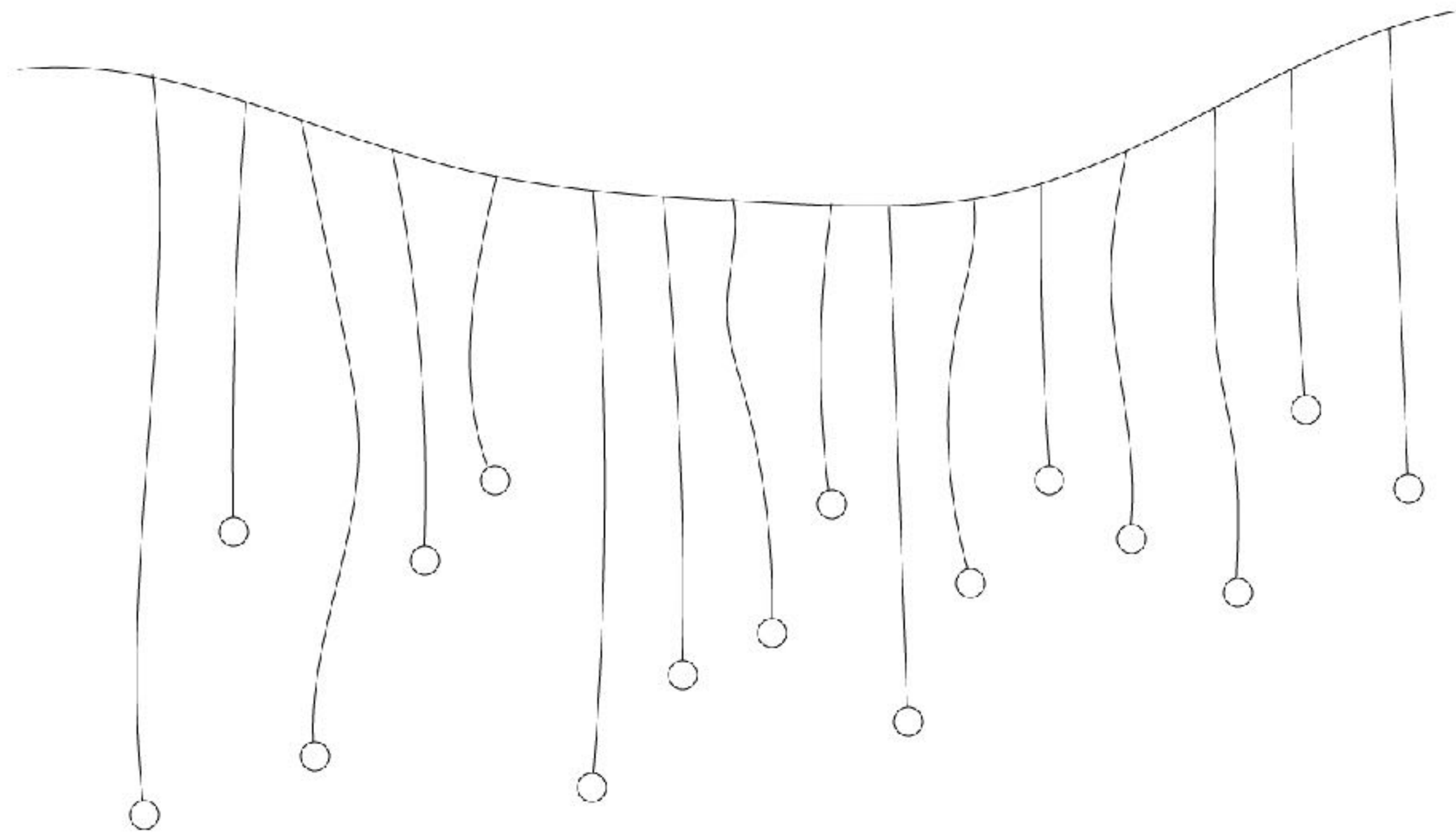
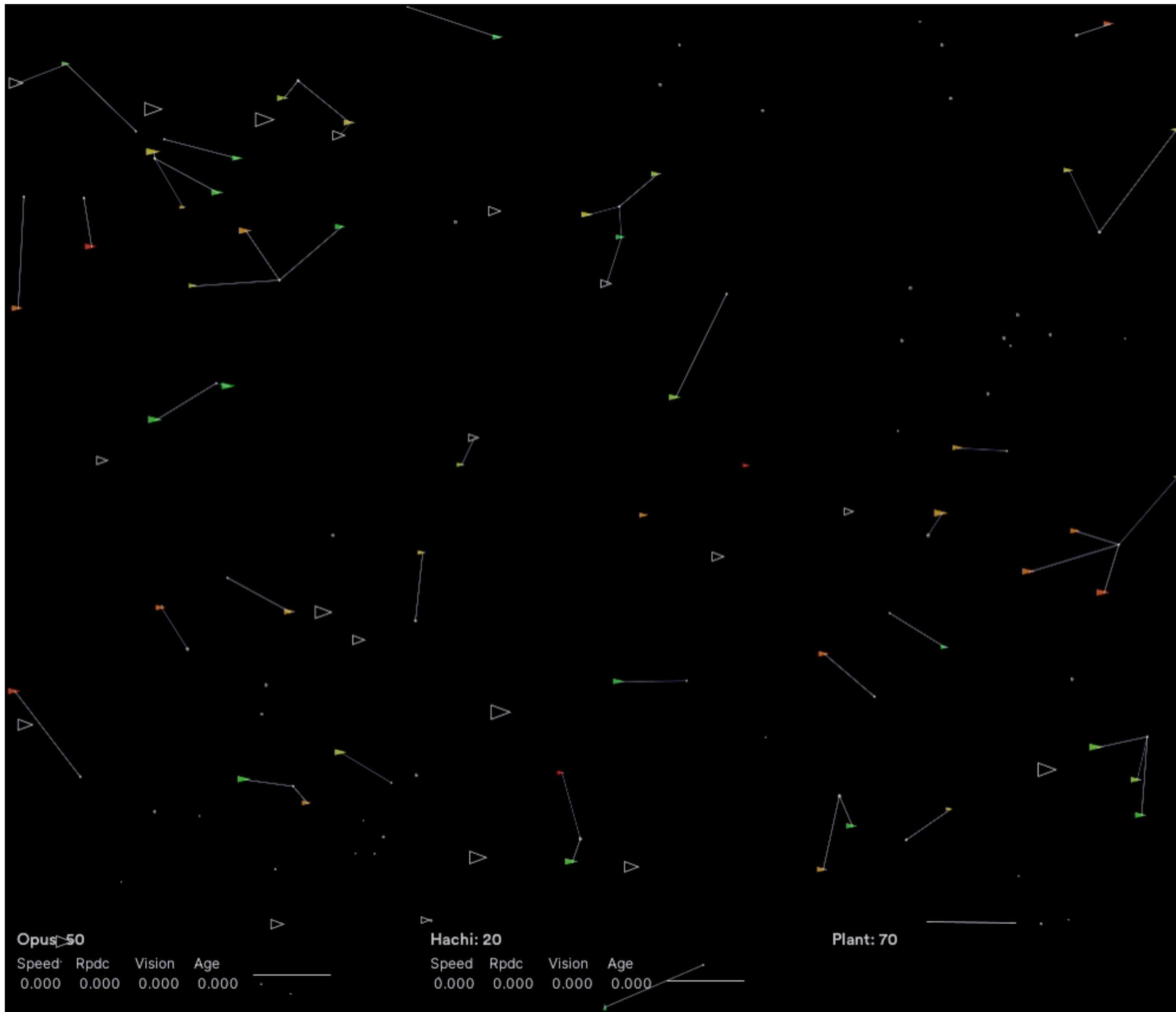

fig 1.1

**Bio-Surveillance Systems**

Designed to detect pheromones and other organic substances to track the happenings in any given area. The long, strings provide for a large catchment area, which can be strung out over structures.















INSTITUT SCIENTIFIQUE DE RECHERCHE PNEUMONALISTE	
V	upokrinomeneas 1
MONOGRAPHIE	
TAXONOMIE	AIRES HYPOCRISIQUES
PRODOTIQUE	upokrinomologie
ZOOTOPHE	NADAL
TAXOPHIE	MORPHOPROPHASISME
ESPECE	VAMPYROTHEONE.E
DATE: 12/1/186	ZOOLOGISTE: L. BEC

## VAMPYROTHEONE EUKELAMPRE

LE VAMPYROTHEONE EUKELAMPRE APPARTIEN A L'ORDRE DES VAMPYROMORPHA. IL EVOLUE DANS UN MILIEU HABAL. SOUTIENS A DE PORTES PRESSIONS ET EST BAROPHILE. SONT ATTITUDE COMPORTEMENTALE EST UROCRINE-NOLOGIQUE ET SE CARACTERISE PAR UN NIMETISME BIOMOTNEOLOGIQUE TANT SUR LE PLAN MORPHOLOGIQUE, PHYSIOLOGIQUE, METABOLIQUE QU'ETHOLOGIQUE.

LE VAMPYROTHEONE EUKELAMPRE EST BIOLUMINESCENT. LES EMISSIONS LUMINEUSES SONT ETUDES PAR LA CADOPHOTIQUE LES EFFETS COMPLEXES ET PARTICULIERS EXERCES SUR LA BIOGENESE, DEVELOPPEMENT CHEZ CERTAINS ORGANISMES UNE SORTA DE FASCINATION DEBOTE ET UN COMMENSALISME DEFINITIF. CERTAINS ZOOLOGISTES ET TECHNOLOGUES FAISANT AUTORITE, ANALYSANT LE SUJET D'UNE "LUMIERE DIVINE ABYSSALE"

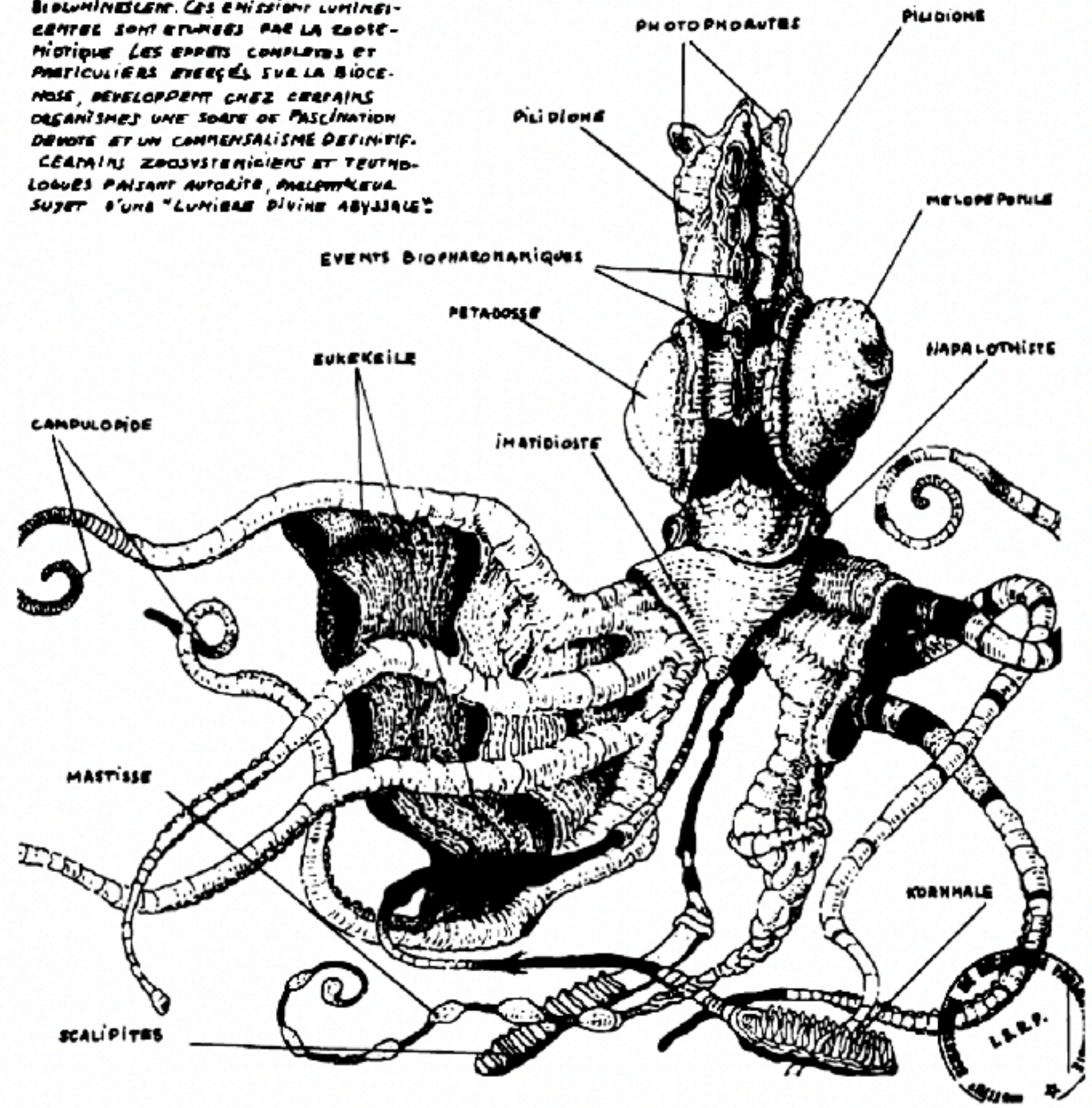

How would the planet judge us?